



Belknap Office Building

503 Belknap Street • Superior WI
For Lease—\$14.00 NNN



Greg Follmer, Broker MN & WI
218-310-0013
gregfollmer@gmail.com

230 E Superior Street • Duluth, MN 55802
218-310-0013 • www.GregFollmer.com
Licensed in MN and Wisconsin



All Information Herein Deemed Reliable but not Guaranteed

Belknap Office Building

503 Belknap Street • Superior WI

Lease Opportunity

Beautiful office space on Belknap Street in Superior, Wisconsin. This 6,430 Square Foot building was built in 2000 and renovated in 2013. Currently vacant this space could be easily divided for two or more smaller users. Ample on-site parking. High traffic counts of 17,000+ cars per day. Sought after high quality space that could fit many needs with little to no renovations.

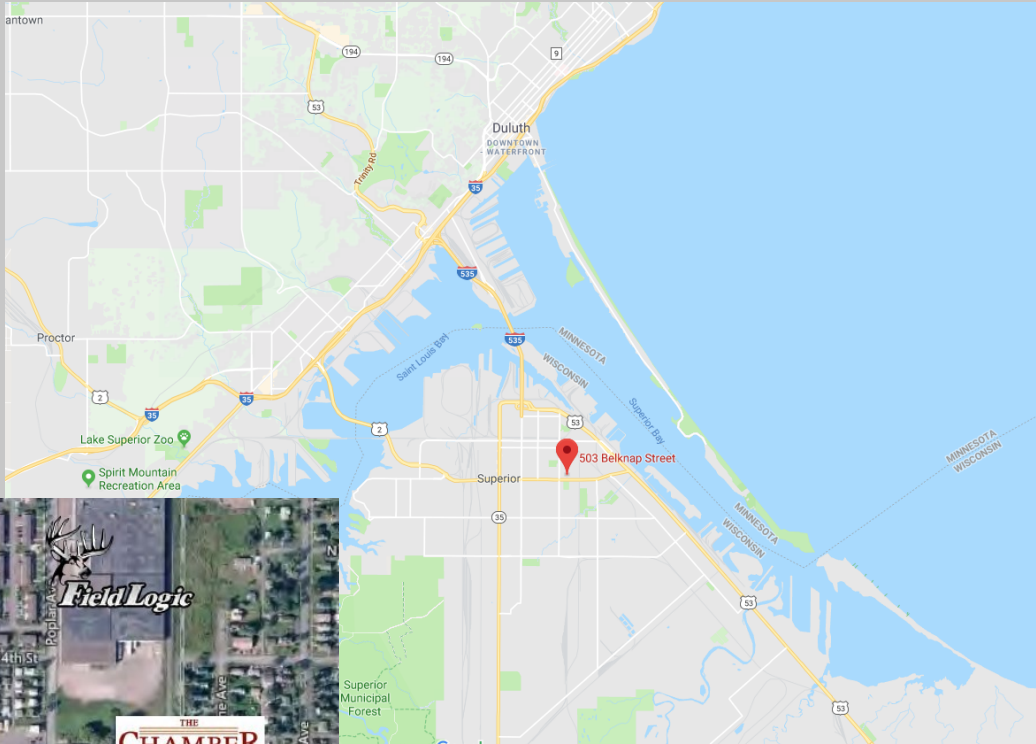

- 0.323 Acre
- 2020 Taxes \$16,762.19
- Built in 2000, renovated in 2013
- 6,430 Square Feet

Greg Follmer, Broker MN & WI
218-310-0013
gregfollmer@gmail.com

230 E Superior Street • Duluth, MN 55802
218-310-0013 • www.GregFollmer.com
Licensed in MN and Wisconsin



Belknap Office Building

503 Belknap Street • Superior WI

Lease Opportunity



Greg Follmer, Broker MN & WI
218-310-0013
gregfollmer@gmail.com

All Information Herein Deemed Reliable but not Guaranteed



230 E Superior Street • Duluth, MN 55802
218-310-0013 • www.GregFollmer.com
Licensed in MN and Wisconsin

Belknap Office Building

503 Belknap Street • Superior WI
Lease Opportunity \$14.00 NNN

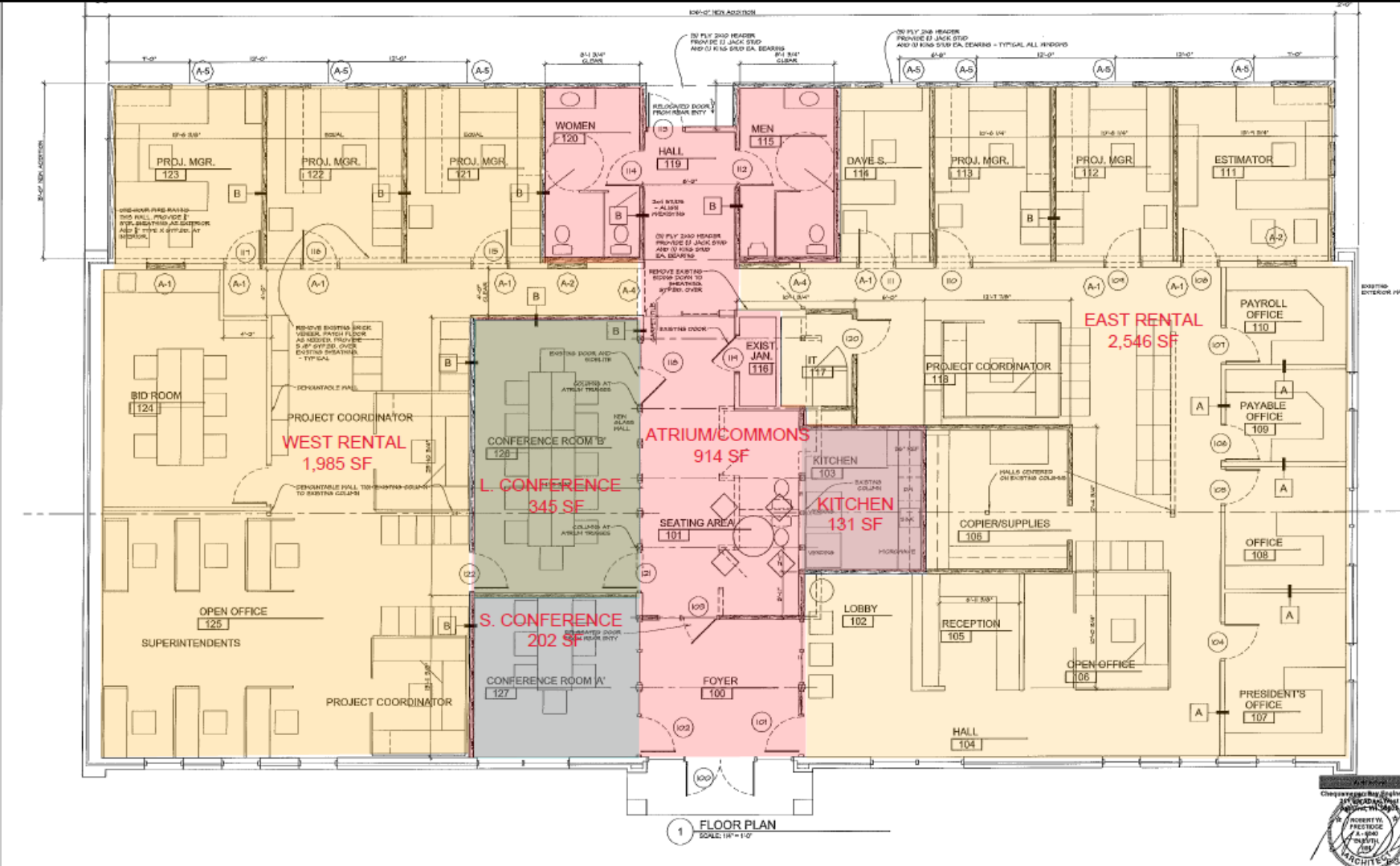

Greg Follmer, Broker MN & WI
218-310-0013
gregfollmer@gmail.com

All Information Herein Deemed Reliable but not Guaranteed

230 E Superior Street • Duluth, MN 55802
218-310-0013 • www.GregFollmer.com
Licensed in MN and Wisconsin