

# Lang Building—Heart of the HART District

206 E Superior St • \$16.00 PSF NNN



Greg Follmer, Broker MN & WI  
218-310-0013 • [gregfollmer@gmail.com](mailto:gregfollmer@gmail.com) • [www.GregFollmer.com](http://www.GregFollmer.com)  
All Information Herein Deemed Reliable but not Guaranteed

# Lang Building—Heart of the HART District

206 E Superior St • \$16.00 PSF NNN



## PROPERTY FEATURES

- +/- 10,000 SF on 2nd Floor
- Across from North Shore Theater
- Alongside Lakewalk and overlooking Ariel Lift Bridge
- Total Building Square Footage +/- 30,000 SF

Built-out to your specs

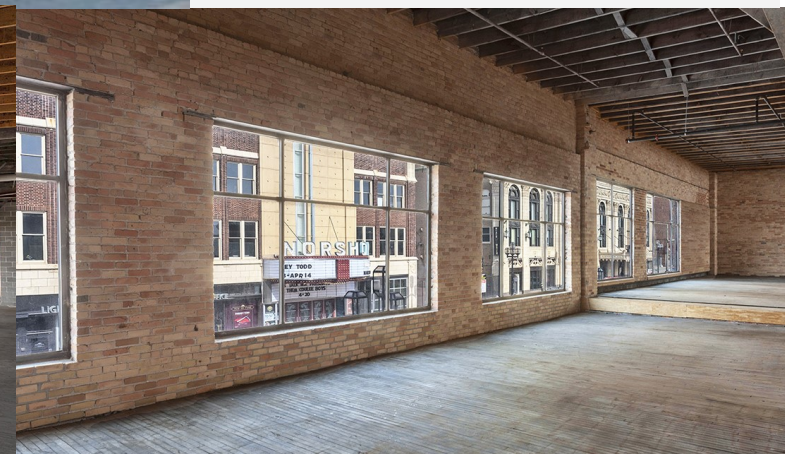

Greg Follmer, Broker MN & WI  
218-310-0013 • [gregfollmer@gmail.com](mailto:gregfollmer@gmail.com) • [www.GregFollmer.com](http://www.GregFollmer.com)  
All Information Herein Deemed Reliable but not Guaranteed

# Lang Building—Heart of the HART District

206 E Superior St • \$16.00 PSF NNN

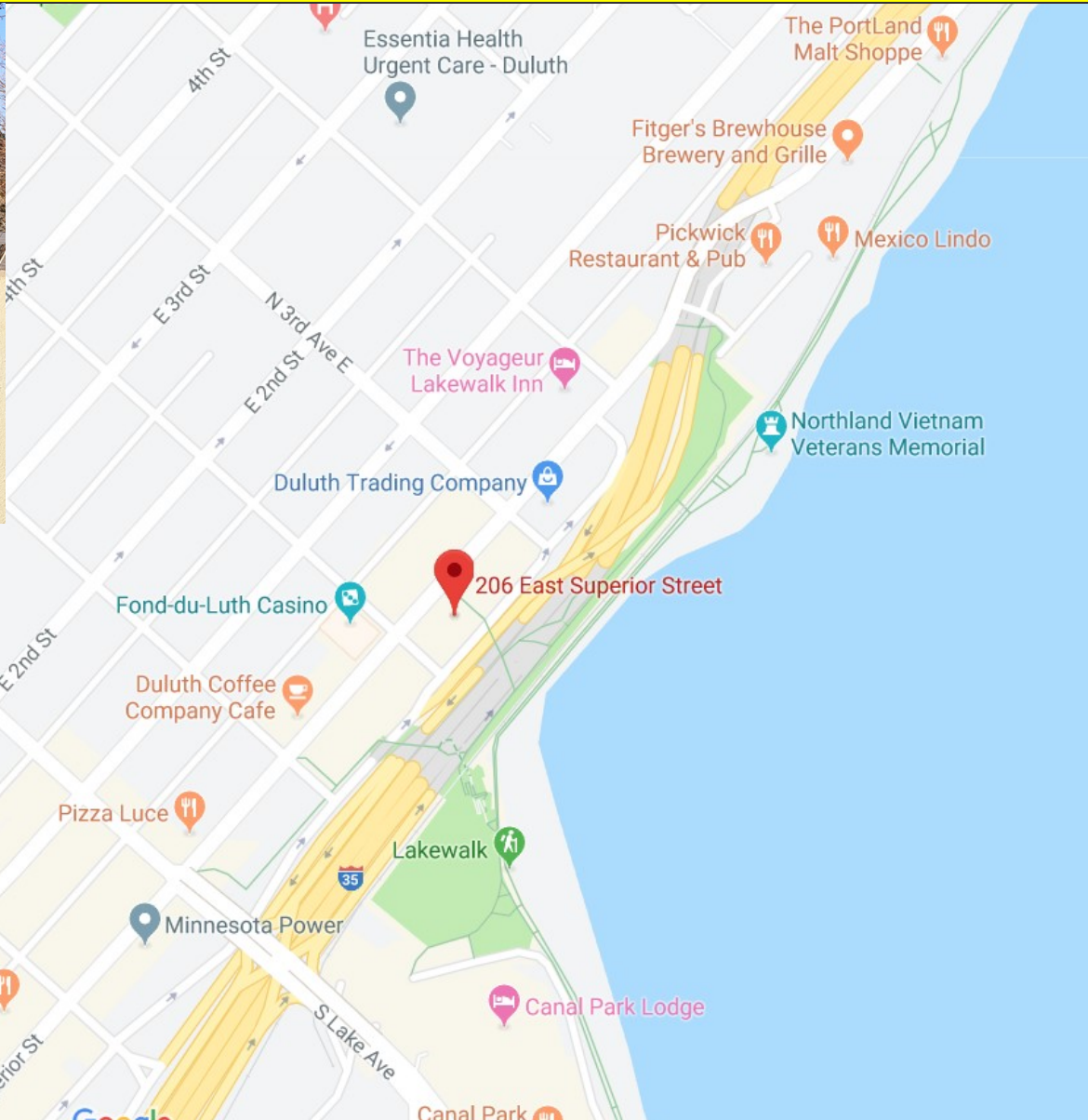
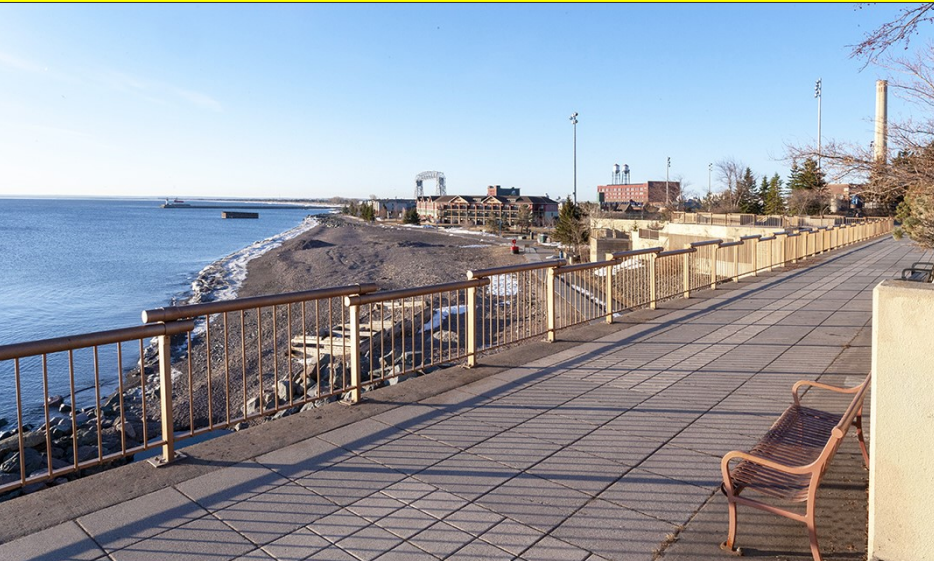

Greg Follmer, Broker MN & WI  
218-310-0013 • [gregfollmer@gmail.com](mailto:gregfollmer@gmail.com) • [www.GregFollmer.com](http://www.GregFollmer.com)  
All Information Herein Deemed Reliable but not Guaranteed